



Night in Bethlehem Ornament

Created by Gloria Plunkett

@designzbygloria.com

I have created this PDF Tutorial for you, hope it helps with the products I used to create this pretty, and super easy Ornament. I also have a video tutorial for you, it can be viewed by copying and pasting this link here:

<https://youtu.be/iIECM77o3wo>

Cardstock: Night of Navy Cardstock, and Sparkle and Silver Glimmer Paper, Whisper White Cardstock

Tools: Classic Label Punch, 3/8" Silver Metallic Edge Ribbon, Silver Mini Sequin, Bethlehem Framelit Dies, Season Chums Stamp Set, Real Red Classic Ink, Stampin' Dimensionals, Mini Stampin' Dimensionals, Tombow Multipurpose Liquid Glue, Layering Circle Framelits, Big Shot, Magnetic Platform

Non-Stampin Up Products: Hot Glue Gun, Half Round Clear Globe (I found mine at Hobby Lobby)

Cut the buildings from the Night of Navy and Sparkle Glimmer Paper. Cut Mary, Joseph & the Donkey from the Sparkle Glimmer Paper, and cut the star from the Starlight Thinlits Dies using Silver Glimmer Paper.

Cut 4 Night of Navy Circle, which are slightly larger than your clear globe ornament using the Layering Circles Framelit Dies. Glue the 4 circles together using your Tombow Multipurpose Liquid Glue.

Cut 1 Night of Navy Circle slightly smaller than the previous circle to ensure you stay inside the globe.

Place your 2 building pieces on the single smaller Night of Navy Cardstock Circle together to figure out how you want your ornament to look like, you will have overhang, and once you have

it set, go ahead and cut around the Circle to remove the overhang.

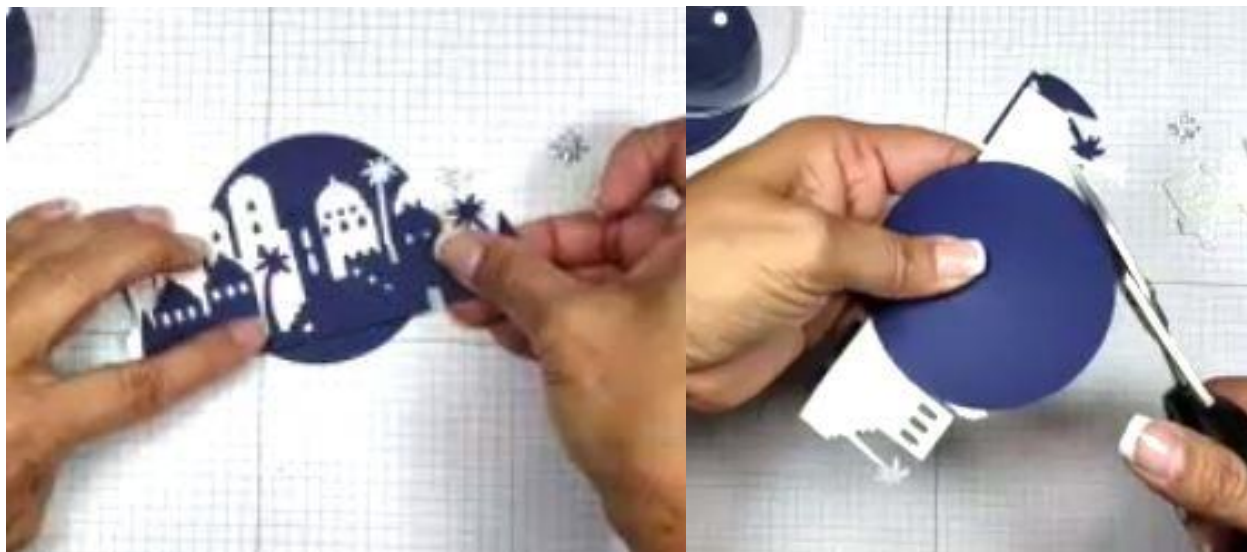

Now add Stampin' Dimensionals to the back of the Sparkle cut buildings (I used both the regular and mini dimensionals) and place your first layer.

Next, add Stampin' Dimensionals to the back of the Night of Navy Buildings and add them on top of the Sparkle Glimmer layer.



Now, add Stampin' Dimensionals to the back of the Mary and Joseph Sparkle Cut piece and adhere it to the top of the Night of Navy buildings.

Lastly, stamp the sentiment from the Seasonal Chums Stamp Set using the Real Red Classic Ink onto a piece of Whisper White Cardstock and punch out using the Classic Label Punch. Adhere the sentiment to using Stampin' Dimensionals atop Mary and Joseph.

Add Tombow Multipurpose Liquid Glue to the back of the Night of Navy Circle we just assembled and glue it to the slightly larger Night of Navy Circles.



Place a bead of Liquid Glue to around the edge of the Night of Navy Circle and place your clear globe ornament on top. Hold for a few seconds to ensure it is firmly stuck.

Add another bead of Liquid Glue on the outside of the ornament and add the Mini Silver Sequin Trim to finished of the outside of the ornament.



Cut a piece of 3/8" Silver Edge Ribbon to create your loop. Next create a both for the top of your ornament using the same ribbon. Adhere the loop first to the top of the clear globe ornament using hot glue, then add the ribbon.



You're done!



Bethlehem
Edgelits Dies -
144676
Price: \$32.00



Starlight Thinlits
Dies - 141840
Price: \$29.00



Layering Circle
Framelits Dies -
141705
Price: \$35.00



Seasonal Chums
Clear-Mount
Stamp Set -
144948
Price: \$21.00



Seasonal Chums
Wood-Mount
Stamp Set -
144945
Price: \$29.00



Sparkle Glimmer
Paper - 146957
Price: \$5.00



Silver Glimmer
Paper - 146960
Price: \$5.00



Night Of Navy 8-
1/2" X 11"
Cardstock -
100867
Price: \$8.50



Whisper White 8-
1/2" X 11"
Cardstock -
100730
Price: \$9.75



Classic Label
Punch - 141491
Price: \$18.00



Silver 3/8"
Metallic-Edge
Ribbon - 144213

Price: \$7.00



Silver Mini Sequin
Trim - 144230

Price: \$6.00



Mini Stampin'
Dimensionals -
144108

Price: \$4.00



Stampin'
Dimensionals -
104430

Price: \$4.00



Multipurpose
Liquid Glue -
110755

Price: \$4.00



Real Red Classic
Stampin' Pad -
147084

Price: \$7.50



Big Shot - 143263

Price: \$110.00



Magnetic Platform
- 130658

Price: \$40.00